

### MIDTOWN STATION

Total Cost: \$2,937,257



#### 10th Street Entry Plaza (Zone C)

- \$64,416 - Granite Plaza Pavement - banding patterns parallel with 10th Street
- \$43,900 - Benches - granite benches with embedded led lights
- \$13,400 - Greenspace - rectangular landscape bands
- \$24,000 - Painted Crosswalk - 10th Street, midblock
- \$50,000 - Sculpture - landmark to entryway
- \$63,200 - Pedestrian Lights - illuminating columns, bollards, and accent lights

\$258,916 \*



#### Station Interior and Façades at Street Level

##### Main Concourse (Zone A)

- \$30,000 - Painted Murals - by local artists, located in the exterior recessed corners
- \$248,486 - Concrete Stain - lighten and brighten interior ceiling and certain walls
- \$17,600 - Information signage - digital monitors broadcast real time transit info
- \$60,000 - Projection - project images on adjacent building or entry plazas
- \$35,400 - Floor Paint - pedestrian traffic coating
- \$240,400 - Lighting - colored glass, LED wall washers and spotlights
- \$50,000 - Color - colored fabric acoustic panels and colored panels of transparent glass
- \$12,600 - Audio - improve announcement clarity, play music

\$694,486 \*



#### Peachtree Place Entry Plaza (Zone E)

- \$72,000 - Granite Plaza Pavement - banding patterns parallel with Peachtree Place
- \$52,680 - Benches - granite benches with embedded led lights
- \$14,600 - Greenspace - rectangular landscape bands
- \$63,200 - Pedestrian Lights - illuminating columns, bollards, and accent lights
- \$7,200 - Painted Crosswalk - Peachtree Place, midblock
- \$109,250 - Transit Tower - digital monitors display live transit schedule
- \$5,795 - ADA Parallel Parking - along north side of Peachtree Place
- \$9,743 - Shuttle and Vehicle Loading Zone - along north side of Peachtree Place
- \$160,000 - Shade Structure - for shuttle/vehicle drop off area

\$494,468 \*

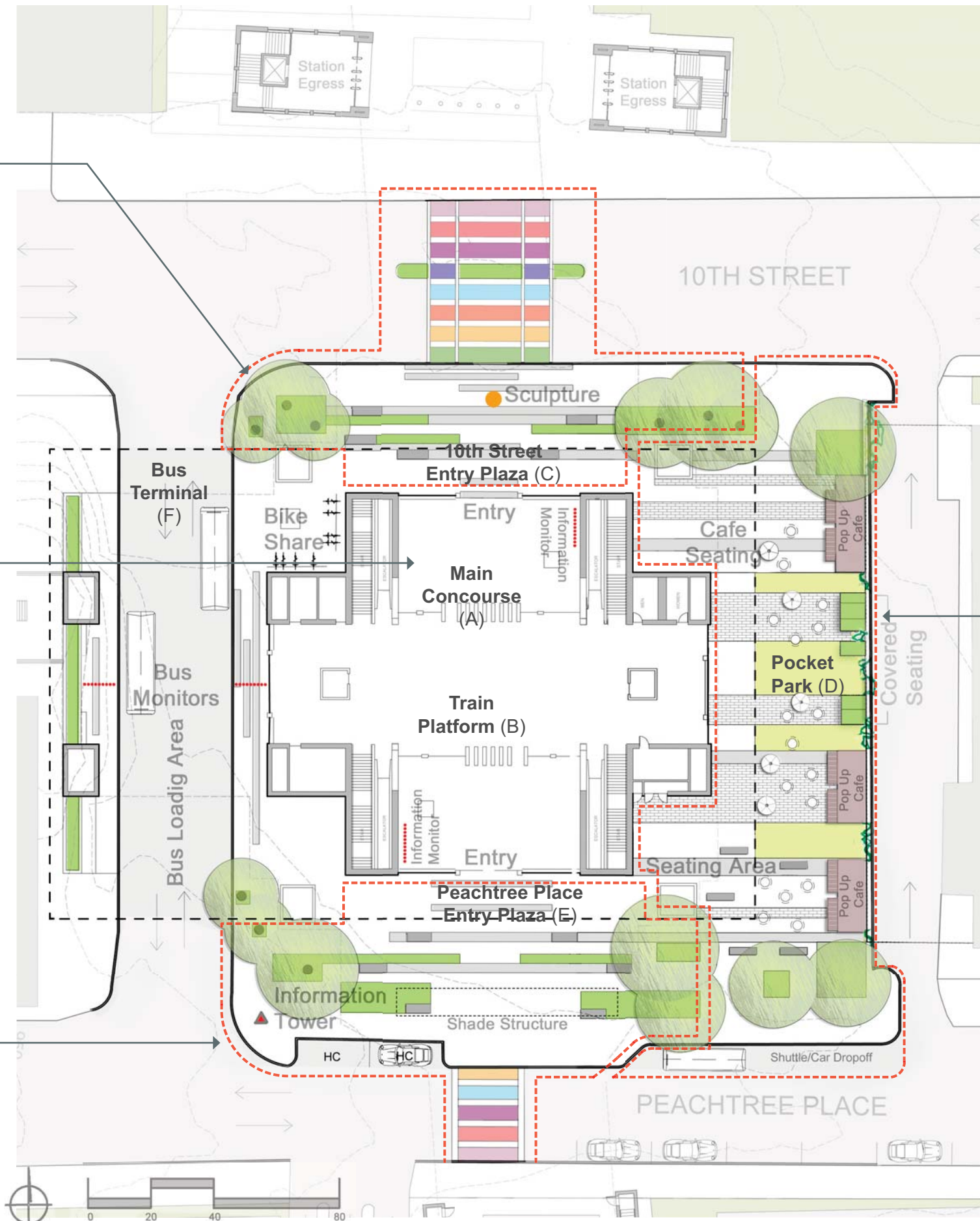

Midtown Station View from Peachtree Place

#### Pocket Park (Zone D)

- \$14,631 - Demolish Parking Lot - convert to active urban pocket park
- \$162,000 - Granite Plaza Pavement - banding patterns parallel with 10th Street
- \$43,900 - Seating Area - Tech Trolley waiting, monolithic granite benches with embedded led lights
- \$191,400 - Furniture Shade Structures - integrated lights and charging stations powered by photovoltaic roof panels
- \$194,480 - Vegetative Screen Fence - along the eastern edge of the plaza between the Pop-up Cafés
- \$40,080 - Collaborative Seats and Tables - steel coffee table with matching chairs
- \$302,400 - Container Cafés - seating area to anchor both ends of the new pocket park
- \$27,800 - Movable Seats and Tables - steel table with matching chairs
- \$20,800 - Greenspace - rectangular landscape bands
- \$61,600 - Pedestrian Lights - illuminating columns, bollards, and accent lights

\$1,059,091 \*

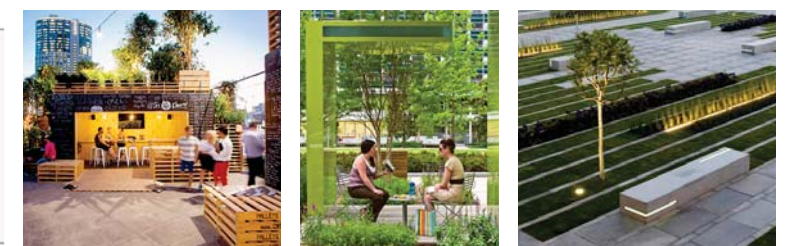

# MIDTOWN ATLANTA

## TRANSIT STATION ENHANCEMENTS

### MIDTOWN STATION



#### Bus Terminal (Zone F)

- \$7,000 - **Lighting** - uplight bus canopy
  - \$12,000 - **Information signage** - digital monitors broadcast real time transit info
  - \$6,500 - **Bike Share** - with repair area and additional parking (by others)
  - \$13,900 - **Seating** - moveable seats and tables
- 
- \$39,400\***



#### Train Platform Level (Zone B)

- \$48,200 - **Lighting** - linear and wall washing lights brighten the tunnel
  - \$170,400 - **Acoustic Panels** - recover acoustical panels with colored fabric
  - \$29,600 - **Information signage** - digital monitors broadcast real time transit info
  - \$23,400 - **Ceiling Fans** - provide air circulation
  - \$34,896 - **Concrete Stain** - lighten and brighten interior ceiling and certain walls
  - \$70,000 - **Technology** - add wifi
  - \$14,400 - **Audio** - improve announcement clarity, play music
- 
- \$390,896\***

\* Preliminary Pricing by Winter Construction

